

BNC Conn. Series

Material & Finish

Body: Zinc Alloy Nickel Plating

Insulator: PBT

Center Contact : Phosphor Bronze , Gold Plating

Mounting Post: Phosphor Bronze / Tin Plating

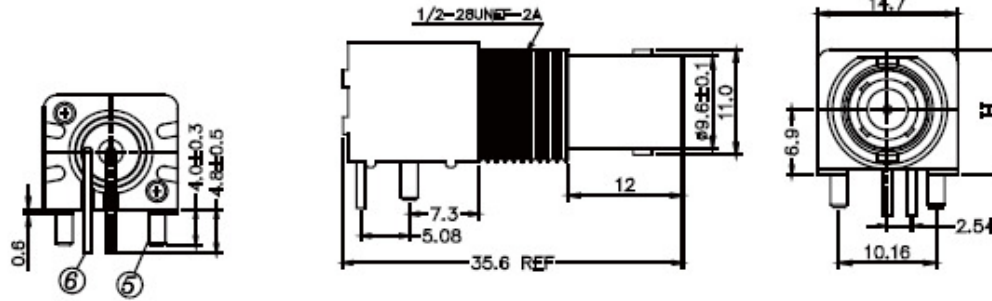

BNCR002-F **GW** **-L**
 5:50 Ω 7:75 Ω 2:H=13.16mm
 3:H=15.8mm



LOCK WASHER



1/2-28UNEF-2B
CLAMP NUT

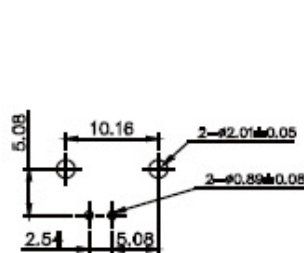

RECOMMENDED PC BOARD LAYOUT
WITHOUT MOUNTING POSTS

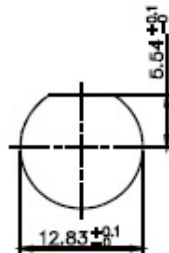

RECOMMENDED MOUNTING HOLE
MAXIMUM PANEL THICKNESS: 5.5MM

TOPTTEK
HARDWARE ELECTRONIC COMPONENTS



www.toptek-co.com